

INTENDED USE

Mekano® CH125-2T5 channels can be fitted back to back with no extra brackets, but junctions can also be reinforced using accessories such as gusset plates and splices.

INSTRUCTION FOR USE

Attach the parts loosely with self locking M12 bolts, adjust and tighten securely. The bolts are easily fitted through the large access holes on the back of the channel section.

CH125 channel is supplied in 3 m lengths, however it can also be jointed using a bolted splice connector.

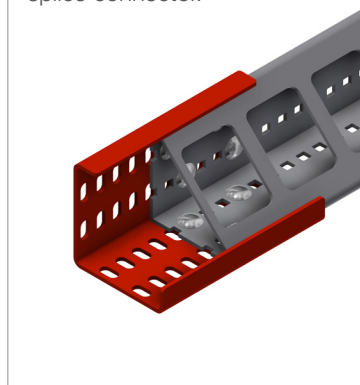

CH125 channel splice.

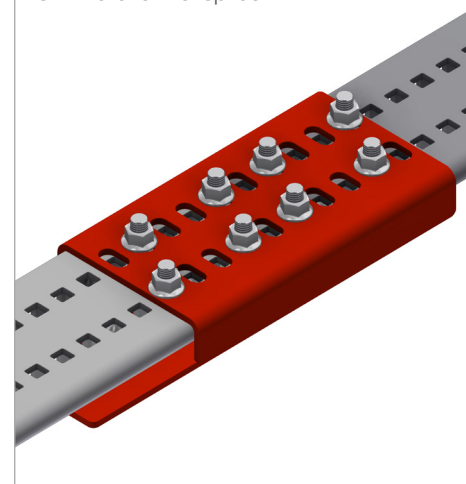

CH125 end caps can be used to cleanly close the end of cut sections. Hold in place with 2 M12 bolts.

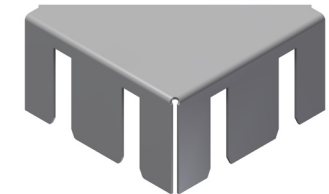

CH125 gusset plates can be used to create X-, T- and L-supports. The Nonie™ principle allows for vertical adjustment in 5 mm increments. Available in 2 types. CH125 and CH100/125

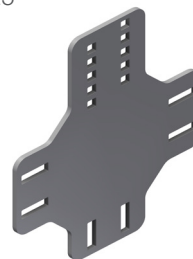

Gusset plate for fixing 2 x CH125 channels.

Gusset plate for fixing CH100 to CH125.

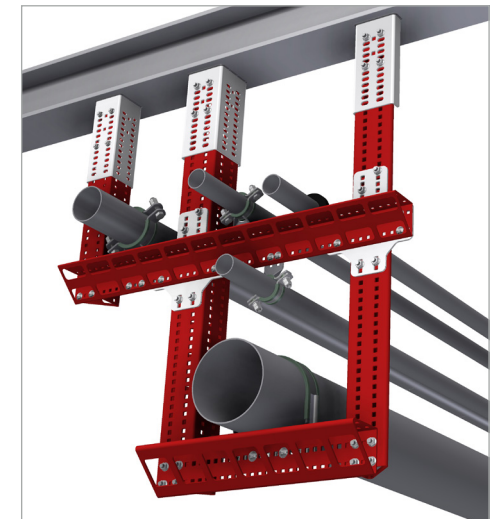
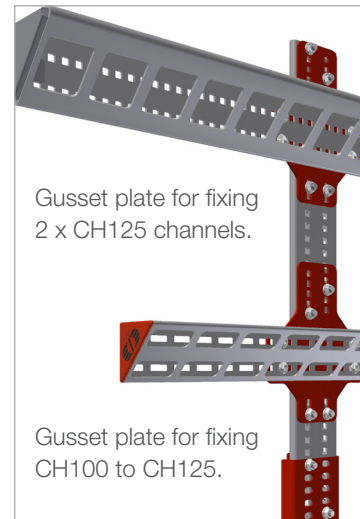

User Guide for Bolts:
Recommended Torque