

## INTENDED USE

Riser locks for locking sides of SPB tray when using Flexi Riser for extra stability. Style of lock depends on the tray type.

Can be used on both inside and outside risers.

## INSTRUCTION FOR USE

Bend the riser in the required angle. Attach the riser lock loosely to the trays using self locking bolts. Adjust and tighten securely.

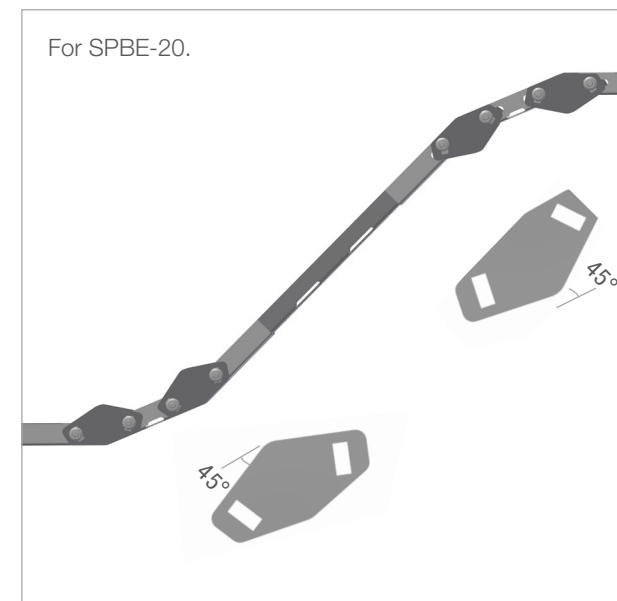
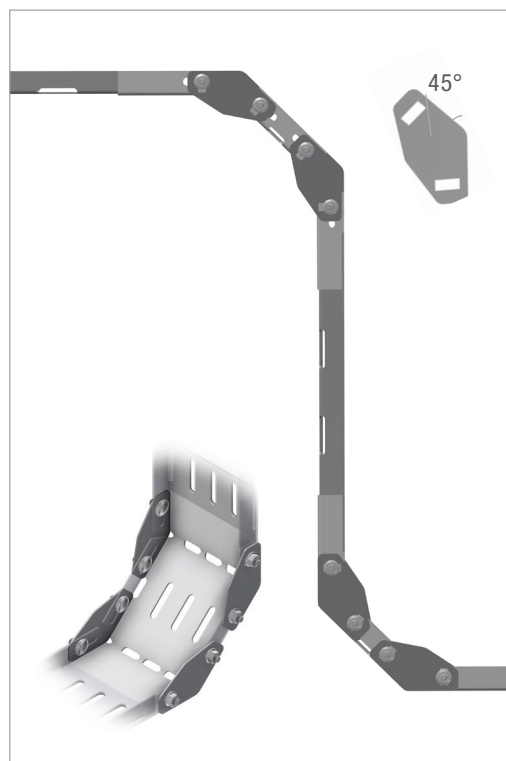
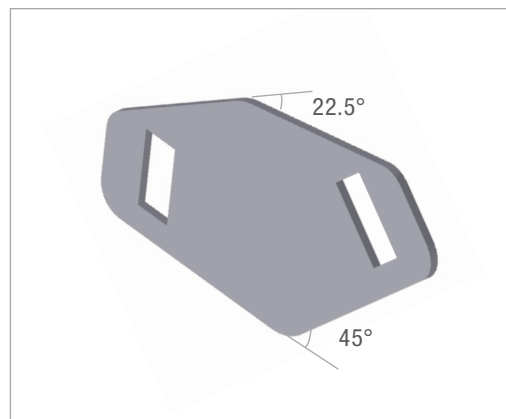

User Guide for Bolts:  
Recommended Torque