

## INTENDED USE

Pre-assembled SHS 80 Floodlight support pole with adjustable Floodlight Support plate with hole pattern to suit most popular floodlight brackets. The bracket allows for 360° adjustment of the Floodlight. Height 1.5 m and depth 0.4 m allows the pole to be fitted to H-beam supports and clear the flange. The fixing plate has a drainage hole at the bottom.

## INSTRUCTION FOR USE

The pole has a fixing bracket which can be welded directly to the structure or can be bolted to threaded doubling plates (bolt CC 150 mm) welded to the structure.

The Floodlight support bracket can then be fitted to the rotation plate using a central bolt, adjusted, then secured with self locking bolts in the required position.

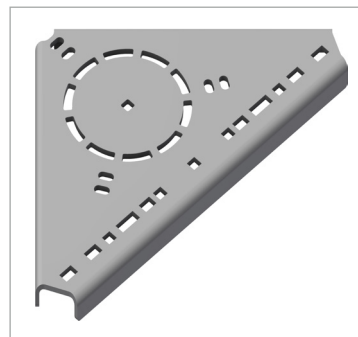
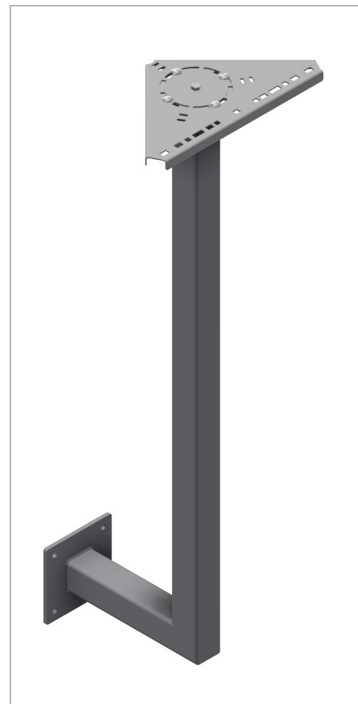

Floodlight support bracket.



Typical installation.



User Guide for Bolts:  
Recommended Torque